



Foldable ModelFor Exterior Use



Seat Upholstery Color/M-5
M-4 M-5

MV-100Manufacturer's Suggested Retail Price (Non-Taxable) ¥42,0007 Inches8 InchesWeight 8.8kgWeight 9.1kg

- Handgrip Height Adjustment
The handgrip height can be adjusted at 11-level increments from 750~890mm (8-inch model) to closely fit the user's body type and posture. Use the user's leg joint area as a reference point to adjust the height to ensure the walker is easy to push.
- Seat Height Adjustment
The seat can be adjusted to a height easy for the user to sit down and stand up. Adjust the seat height to 450mm or 470mm for the 8-inch model, or 440mm or 460mm for the 7-inch model.
- Special Bag Included
A bag with an original design is included as a standard feature to store small items. It is especially useful during small outings and shopping.

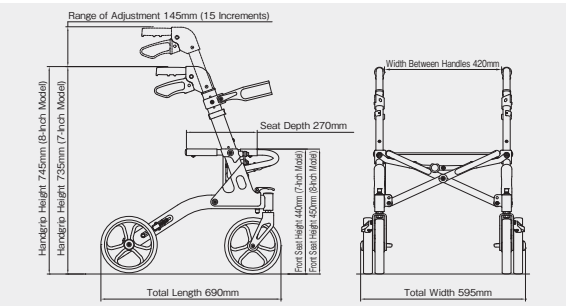

Product Number	Width Between Handles	Total Width	Total Length	Total Height	Seat Height
8-Inch Model	420	600	690	750~890 (11 Levels)	450/470 (2 Levels)
7-Inch Model	420	600	690	740~880 (11 Levels)	440/460 (2 Levels)

* The total height changes according to the handgrip height (11-level adjustable at 15mm increments). * Weight: The weight of the special bag is not included. (The bag weight 200g.)
* The factory setting of the seat height is 450mm (8-inch model) or 440mm (7-inch model). © Specifications are subject to change without prior notice for continual product improvement.

Compact Storage Under Eaves and in Front Entrances

The walker can be compactly folded to a total width of 270mm. It can be stored in narrow spaces like front entrances and under eaves.



Seat Upholstery Color/M-4

Easy to Load onto the Car Trunk

The total width of the (8-inch) walker is 270mm, the depth is 750mm, and the height is 520mm when compactly folded. It is easy to store in the car trunk when going on drives.



Options Exclusive to OLive



Walking Cane Holder (Small)Suggested Retail Price (Non-Taxable) ¥5,000UP

This can hold one walking cane. Please take the walking cane out of the holder before folding its handgrips backwards.



ResistorSuggested Retail Price (Non-Taxable) ¥9,000UP

The speed can be adjusted depending on walking conditions for safety.



Tipping-LessNo Additional Fees

This is option is offered by the manufacturer. (This part is not sold separately. Please ask for this option at the time of order.)

Standard Model (Fixed Backrest)

New Concept - Compact Wheelchair.



Seat Upholstery Color/Red

Red Beige

Front Seat Height 470 mmMV-2Discretionary PriceCaster x Rear Wheel [Inches] 4×6Weight 6.2kg

Product Number	Front Seat Height	Seat Width	Rear Seat Height	Armrest Height	Backrest Height	Footrest Length	Total Width	Total Length	Total Height	Total Width (Folded)	Total Height (Folded)
MV-2	470	350	450	220	330	315	445	730	915	310	610

Unit: mm
© Specifications are subject to change without prior notice for continual product improvement.



Seat Upholstery Color/Beige

- Ultra-lightweight! Weighs Only 6.2kg
- This can be used anywhere with its ultra-compact design. It is especially useful in public spaces and narrow entrances of bullet trains and buses. It is the perfect companion for outings.
- All it takes is one touch to fold the wheelchair up. Its one-touch footbrake is a standard feature.
- The highly practical casters rotate smoothly even on uneven terrain.

Standard Model (Fixed Backrest)

Safe and Comfortable. An All-Around Walking Aid for a Tireless Walk.



Seat Upholstery Color/Aqua Blue

BY-1 Broad Flowers (BF)

Front Seat Height 440 mmMV-10(Tax Included) ¥40,700Caster x Rear Wheel [Inches] 4×4Weight 3.5kg

Product Number	Front Seat Height	Seat Width	Rear Seat Height	Total Width	Total Length	Total Height	Total Width (Folded)	Total Height (Folded)
MV-10	440	270	405	390	615	780~925	240	860

Unit: mm
© Specifications are subject to change without prior notice for continual product improvement.



Seat Upholstery Color/Broad Flowers

- Ultra Lightweight! Only 3.5kg for One-Handed Lifting
- Aluminum pipes are used for the main frame. It is painted with our company's exclusive surface coating for a high quality finish.
- All it takes is one touch to fold the walking aid up for easy storage. It doubles as a very convenient chair for when the user is tired.
- The bag for storing small items is a standard feature.

* This is not a wheelchair. Please do not move it with a person seated on top.

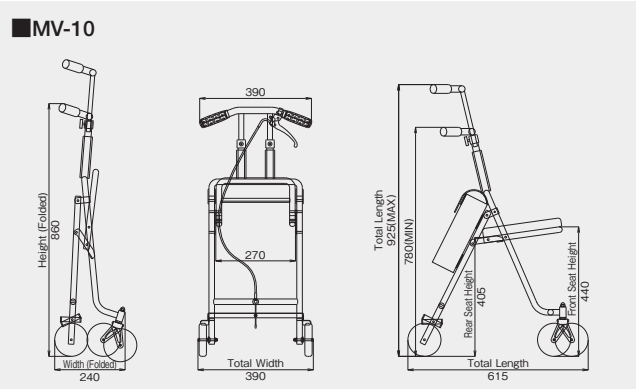
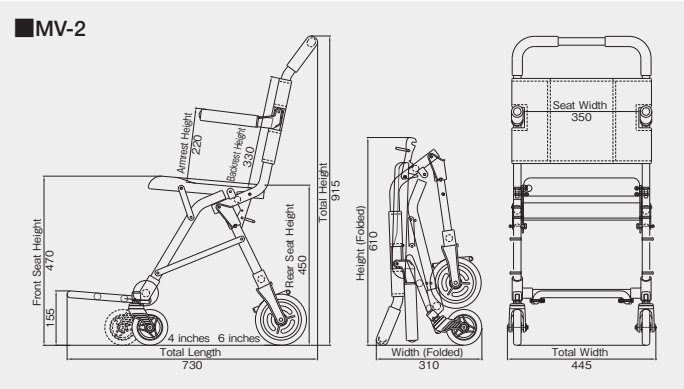

4-Wheel • 6-Wheel Walker

A Safe and Reliable Item to
Take Steps Forward.



SM-30 (4-Wheeler)

Manufacturer's Suggested Retail Price
(Non-Taxable) **¥61,600**

Weight
12.3kg

Unit: mm

Product Number	① Inner Width of U-Shape	② Inner Depth of U-Shape	③ Total Width	④ Total Length	⑤ Total Height	⑥ Total Width (Folded)	⑦ Total Height (Folded)	⑧ Turning Radius
SM-30	330~430	425	550~650	725	860~1,200	260	1,075	755~860

◎ Specifications are subject to change without prior notice for continual product improvement.
* ⑧ Turning radius...755mm when ① is 330mm, or 860mm when ① is 430mm



SM-35 (6-Wheeler)

Manufacturer's Suggested Retail Price
(Non-Taxable) **¥70,400**

Weight
13.3kg

Unit: mm

Product Number	① Inner Width of U-Shape	② Inner Depth of U-Shape	③ Total Width	④ Total Length	⑤ Total Height	⑥ Total Width (Folded)	⑦ Total Height (Folded)	⑧ Turning Radius
SM-35	330~430	425	550~650	725	860~1,200	260	1,075	445~475

◎ Specifications are subject to change without prior notice for continual product improvement.
* ⑧ Turning radius...445mm when ① is 330mm, or 475mm when ① is 430mm

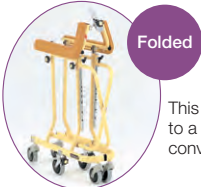

Folded

This model can be converted to a 4-wheel model to use as a conventional walker.



SM-40 (6-Wheeler with Brakes)

Manufacturer's Suggested Retail Price
(Non-Taxable) **¥77,000**

Weight
14.4kg

Unit: mm

Product Number	① Inner Width of U-Shape	② Inner Depth of U-Shape	③ Total Width	④ Total Length	⑤ Total Height	⑥ Total Width (Folded)	⑦ Total Height (Folded)	⑧ Turning Radius
SM-40	330~430	425	550~650	725	860~1,200	260	1,075	445~475

◎ Specifications are subject to change without prior notice for continual product improvement.
* ⑧ Turning radius...445mm when ① is 330mm, or 475mm when ① is 430mm

Specifications

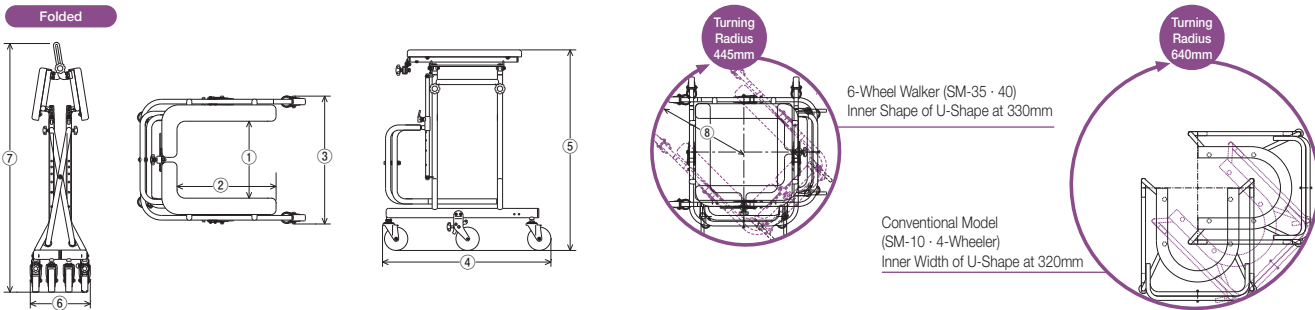

Feature. 1

Resistor

The resistor can be fixed onto the walker using screws. It can be adjusted according to the physical condition of the user for safe use under optimal settings.

Feature. 2

Width Adjustment

Adjust the width of the walker by raising or lowering the X-shaped section. This mechanism is 6-level adjustable for use by a wide range of users from shorter to taller users. (Inner Width of U-Shape 330~430mm)

Feature. 3

Height Adjustment

Similar to conventional walkers, the U-shape section is height adjustable to an optimal setting for the user's body size and physical condition.

Reciprocal Walking Frame/Standard Walking Frame

Anterior • Posterior Rubber Tips Model



CMS-90A



Folded

CMS-90A

(Reciprocal Walking Frame)

Manufacturer's Suggested Retail Price
(Non-Taxable) **¥18,000**

Weight
2.6kg

CMS-90B

(Standard Walking Frame)

Manufacturer's Suggested Retail Price
(Non-Taxable) **¥16,800**

Weight
2.6kg

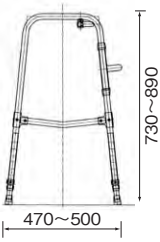

Unit: mm

Product Number		Width Between Handgrips	Total Width	Total Length	Total Height	Diameter (Rubber Tips)	Color
CMS-90A	Reciprocal	460	550	470~500	730~890	19	Silver
CMS-90B	Standard	460	550	470~500	730~890	19	Silver

◎ Specifications are subject to change without prior notice for continual product improvement.

Anterior Swivel Caster Posterior Rubber Tip Model



CMS-91B

CMS-91A

(Reciprocal Walking Frame)

Manufacturer's Suggested Retail Price
(Non-Taxable) **¥21,600**

Weight
2.8kg

CMS-91B

(Standard Walking Frame)

Manufacturer's Suggested Retail Price
(Non-Taxable) **¥20,400**

Weight
2.8kg

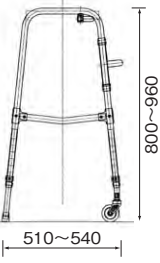

Unit: mm

Product Number		Width Between Handgrips	Total Width	Total Length	Total Height	Diameter (Rubber Tips)	Color
CMS-91A	Reciprocal	460	550	510~540	800~960	19	Silver
CMS-91B	Standard	460	550	510~540	800~960	19	Silver

◎ Specifications are subject to change without prior notice for continual product improvement.

Anterior Swivel Caster Posterior Elastic Caster Model



CMS-92B

CMS-92A

(Reciprocal Walking Frame)

Manufacturer's Suggested Retail Price
(Non-Taxable) **¥24,000**

Weight
2.9kg

CMS-92B

(Standard Walking Frame)

Manufacturer's Suggested Retail Price
(Non-Taxable) **¥22,800**

Weight
2.9kg

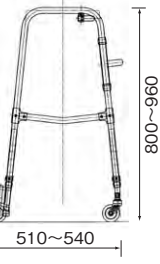

Unit: mm

Product Number		Width Between Handgrips	Total Width	Total Length	Total Height	Color
CMS-92A	Reciprocal	460	550	510~540	800~960	Silver
CMS-92B	Standard	460	550	510~540	800~960	Silver

◎ Specifications are subject to change without prior notice for continual product improvement.

Rubber Tips for Walking Canes

(Crutches, Quad Canes, Foldable Cane, Single Point Canes · Height Adjustable Walking Canes, Lofstrand Crutches, Seven Crutches)

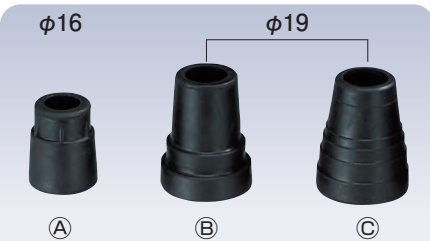

These rubber tips are for crutches and quad canes.
Two sizes for $\phi 16$ or $\phi 19$ tips are available.
A...CMS-40S/M/L
B...CMS-60S/L · CMS-70S/M/L
C...CMS-80S/M/L

Rotating e-Pins

- Uses Rotating e-Pins
- Height Adjustable & Easy to Operate



Insert the pin inside the hole of the pipe and rotate to lock securely.